

Equipment

When showing in the obedience ring, a buckle collar, slip collar, or martingale collar are the only acceptable collars to use.

Leashes are to be 6 feet in length and made of leather or fabric. Head halters may be used only outside the show ring and staging areas.

No tags of any kind are to be on the collar. Dogs being raised for the service dog programs are exempt from the collar tag rule.

Flea and tick collars cannot be worn for judging. Muzzles, prong/pinch collars, or electronic collars of any type are prohibited.

HOW TO MEASURE FOR A DOG COLLAR:



① Measure the widest point of your dog's head, wrapping under the chin and around the back of the head, right behind its ears.

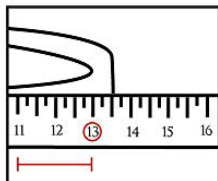

② Add 2 inches to the measurement and choose the chain length closest to this number. If the number is between sizes, choose the larger one.

There is a right way and a wrong way to put on chain collar. If you put it on correctly, the chain will easily release once the correction is complete. If you put it on wrong, the chain may still release, but not as quickly or easily as it should. This is where a dog may learn to hate these things. "Hey! I did what you wanted, why won't you let up?"

YOUR DOG WILL BE ON YOUR LEFT SIDE

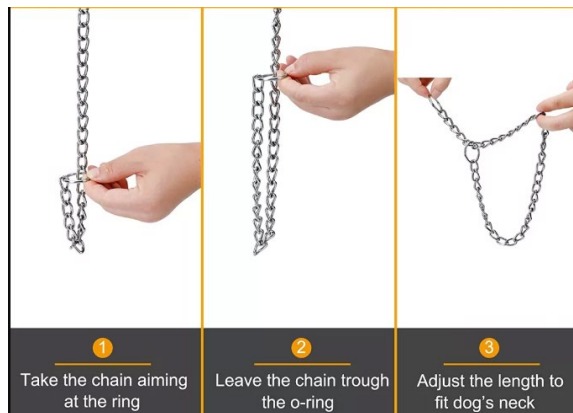

Facing your dog, position the collar so that it makes a letter "P"



Place the chain over the head, maintaining that letter "P" shape.

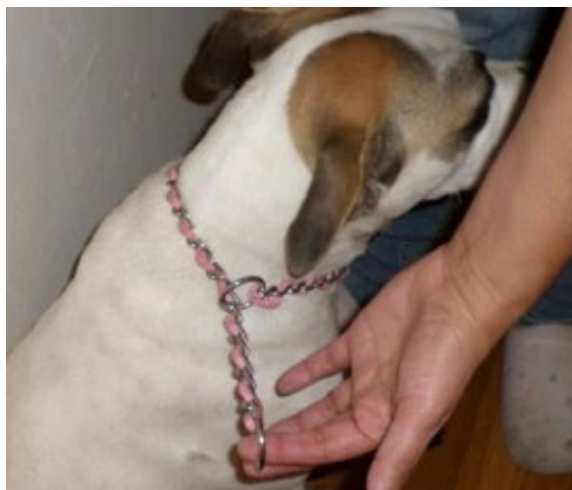

If the collar is placed correctly, the chain will pull straight through the ring. Again, this is for when your dog will be on your left during training.